



**Keward Avenue
Wells
Somerset
BA5 ITS**

Rent

£636.08 per month

*(subject to annual rent review –
this amount may change prior to
your tenancy start date)*

Bedrooms: 3

Reception rooms: 2



Council Tax Band: C

EPC Rating: D



Property Features:

Semi-detached
Gas central heating
Full double glazing
Front garden
Rear garden

Items to be removed:

Coal fire in lounge

**This property is located in Somerset, please click
[here](#) to view a map.**

**To be available in 12 months
from reservation.**

HOUSING BULLETIN



To nearest station:

Castle Cary

11.2 miles

To nearest bus stop:

0.4 miles

To nearest shops:

Lidl

0.4 miles

To nearest GP/Hospital:

West Mendip Hospital

4.0 miles



To nearest church:

St Cuthberts

0.5 miles

Local Diocese:

Bath and Wells





Keward Avenue, Wells, BA5

Approximate Area = 811 sq ft / 75 sq m

For identification only - Not to scale

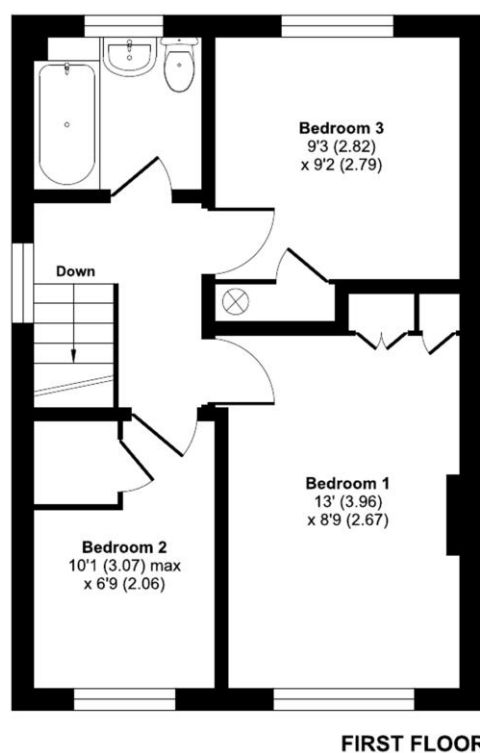
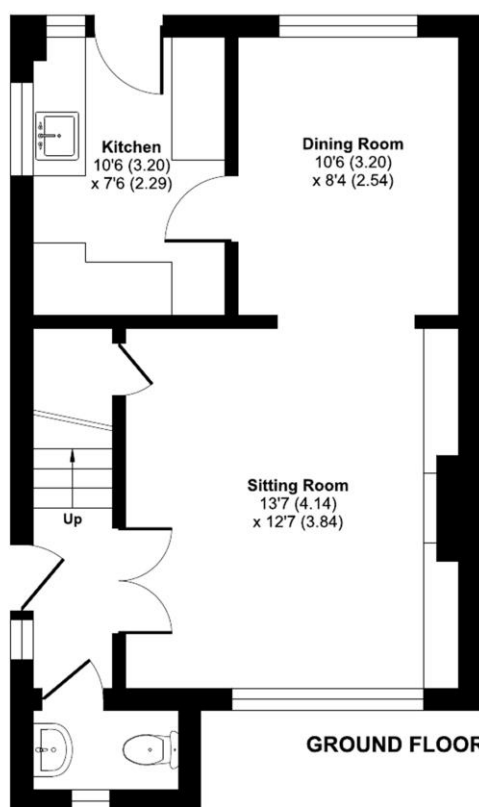

Floor plan produced in accordance with RICS Property Measurement Standards incorporating International Property Measurement Standards (IPMS2 Residential). © nichecom 2022. Produced for Church of England Pensions Board. REF: 830297