



**Clock Tower Court
Park Avenue
Bexhill On Sea
East Sussex
TN39 3HP**

Rent

£568.92 per month

*(subject to annual rent review –
this amount may change prior to
your tenancy start date)*

Bedrooms: 2

Reception rooms: 1



Council Tax Band: C

EPC Rating: D



Property Features:

Ground floor flat

Gas central heating

**This property is located in East Sussex, please
click [here](#) to view a map.**

**To be available in 12 months
from reservation.**

HOUSING BULLETIN



To nearest station:

Collington

0.5 miles

To nearest bus stop:

0.2 miles

To nearest shops:

0.5 miles

To nearest GP/Hospital:

Bexhill Hospital

6.7 miles

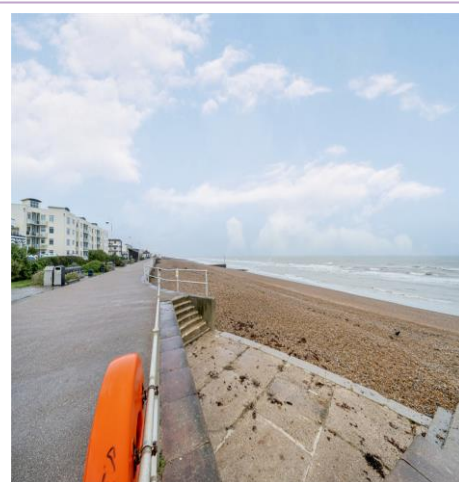

To nearest church:

St Augustine

0.4 miles

Local Diocese:

Chichester



Park Avenue, Bexhill-on-Sea, TN39

Approximate Area = 755 sq ft / 70.1 sq m

For identification only - Not to scale

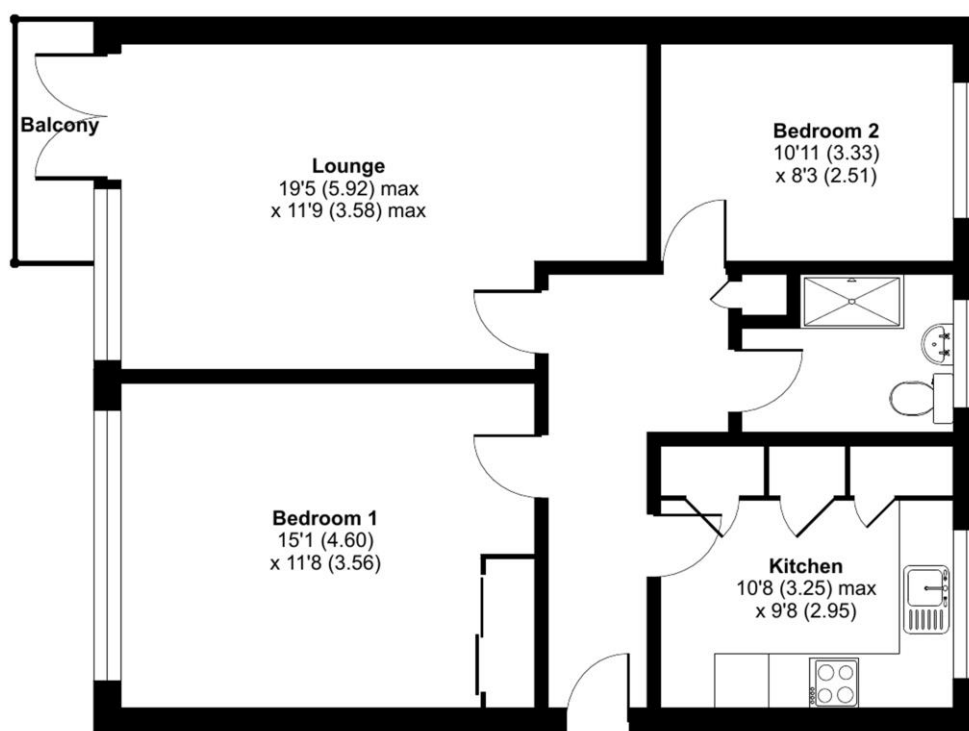

GROUND FLOOR



Floor plan produced in accordance with RICS Property Measurement Standards incorporating International Property Measurement Standards (IPMS2 Residential). © richcom 2022. Produced for Church of England Pensions Board. REF: 932874