



## At a glance

- 27 flats. Re-built in 1997
- Staff on site 365 days a year
- Warden call system including remote careline support outside staffing hours
- Integral fire alarm and protection
- Chapel, communal dining room, activities room, small lounge, library area, laundry, and gardens
- Site fully accessible by wheelchair – flats above ground floor have lift access
- Regular social activities
- Lunch provided daily
- Guest facilities
- Assured tenancy
- Pets allowed

Ramsay Hall has the distinction of being the first home to have been opened by the Church of England Pensions Board. It was originally opened on the 4th December 1948 and closed in 1995 for major refurbishments, re-opening in 1997 and winning a 1998 'Distinction in building' award.

The building is situated close to the seafront in the seaside town of Worthing, West Sussex. We have 11 large 1 bedroom flats for double occupancy and 16 smaller 1 bedroom flats for single occupancy. All the flats have their own kitchen and bathroom and a spacious living area.

We have a large communal garden which is looked after by a member of staff. There is an on-site Chapel, residents lounge and activities room and outside there is a purpose-built storage area for mobility scooters.

One of the big attractions of Ramsay Hall is its prime location. We are just a short stroll away from the promenade and the main shopping area and the local Doctors surgery is just a few minutes' walk away.

**Scroll through the images below to see the Ramsay Hall gallery.**



































## Community

Ramsay Hall has a strong community spirit. Daily 'Morning Coffee' and 'Afternoon tea' is served in our communal dining room where residents also gather for lunch every day. There are weekly chapel services run by residents for the residents. We have a dedicated and professional on-site staff team who work together to provide residents with a range of services.

There is also a small on-site shop which is also run by residents for residents. If you move to Ramsay Hall you can buy essential grocery items without having to set foot outside the building if you don't want to.











# Catering

We have a large kitchen, which would be the envy of many restaurants, and a dedicated catering team who provide lunch each day. Our team work hard to offer a variety of choices and options, and make sure we cater for special dietary needs. We are delighted to have a five-star hygiene rating from the local authority.

# Support

We have a small team of support workers who can provide a wide variety of services to help you live as independently as possible, based on what your needs are. This could be giving you some help with doing your laundry, giving you welfare advice or perhaps just to have a friendly chat.

We do not provide personal or nursing care, but care packages can be organised with our help from external agencies. Every flat is fitted with a 24-hour warden call system which can be used to call for assistance from either the staff on site or the call centre when out of hours. Our goal is to ensure that Ramsay Hall is a home for life so we will support you in any way we can.

# Chapel Life

The Ramsay Hall Chapel is run by residents for residents. We hold services twice a week on a Wednesday and Sunday as well as daily morning prayer to mark special occasions.



# Social

We run a number of social activities at Ramsay Hall during the year including summer barbecues, strawberry teas, Christmas carol concerts and many other events where your friends and family would be welcome to join us.



# Flat layout

Our flats vary in layout, but all have ample storage with large storage cupboards in the hallway and built in wardrobes in the bedroom. Please see below for an example of a typical double and typical single flat layouts.

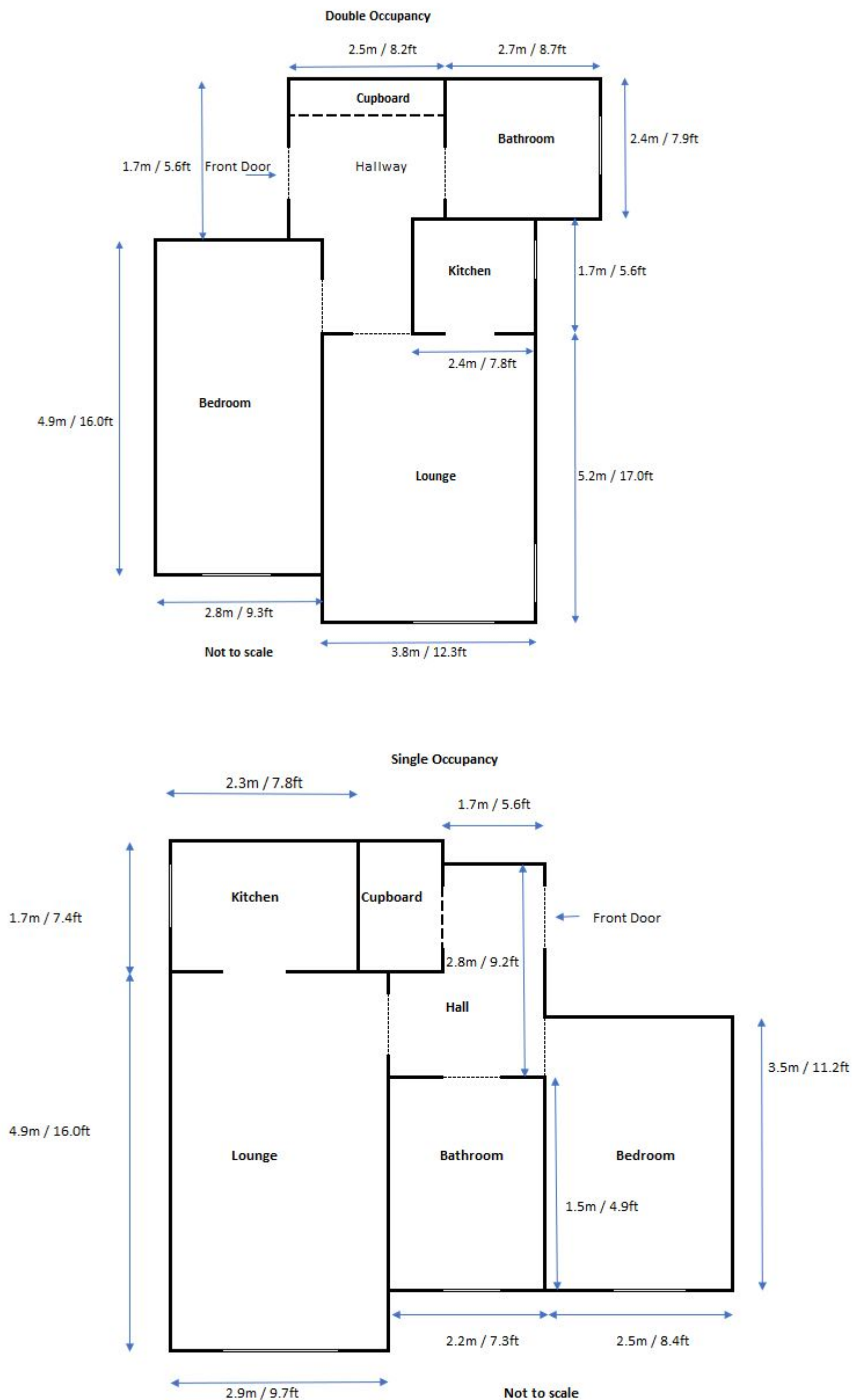

# Contact

Please call Millie and Sharon at Ramsay Hall for further details on the scheme, monthly charges or to arrange a visit.

**Manager:** Millie Harris

**Deputy Manager:** Sharon Carter

**Telephone:** 01903 235045

**Email:** [amelia.harris@churchofengland.org](mailto:amelia.harris@churchofengland.org), [sharon.carter@churchofengland.org](mailto:sharon.carter@churchofengland.org)

**Address:** Ramsay Hall Supported Housing, 9-13 Byron Road, Worthing, West Sussex BN11 3HN

---

**Source URL:** <https://www.churchofengland.org/resources/clergy-resources/retirement-housing/community-living/individual-schemes/ramsay-hall>