

Edgeley: St Mary's (Test)
Quinquennial Inspection
20/11/2018

Name: Edgeley: St Mary's (Test)

Record Type: Church

Churchcode: 647002

Diocese: Borchester (Test)

Archdeaconry: Felpersham (Test)

Parish: Borchester



Exterior of 647002 Edgeley: St Mary's (Test)

Originator: Internet

Surveyor name: James Miles (Test)

Surveyor address: Church House,
Westminster,
London

Survey date: 20/11/2018

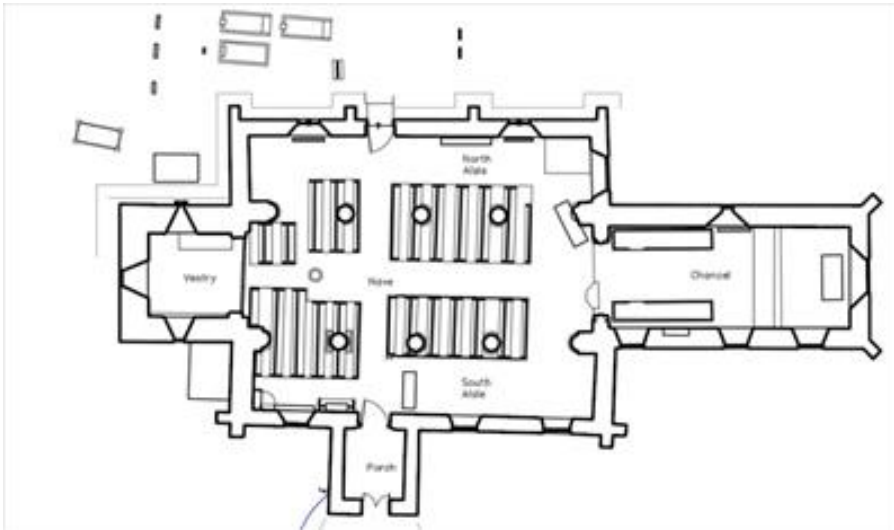

An example plan of a church

Originator: Internet

Approximate date: Post Medieval

Footprint of Church buildings (m2): 100

This is a grade I listed building: 123456

There is a Scheduled Monument within the curtilage or precinct.

This church is not on the Heritage at Risk Register.

This church is in the following National Park: National Park example.

The church is not in a Conservation Area.

The church has evidence of bats.

The church/building is consecrated.

The churchyard has been used for burial.

The churchyard is used for burial.

The churchyard is closed for burial.

The churchyard does have war graves.

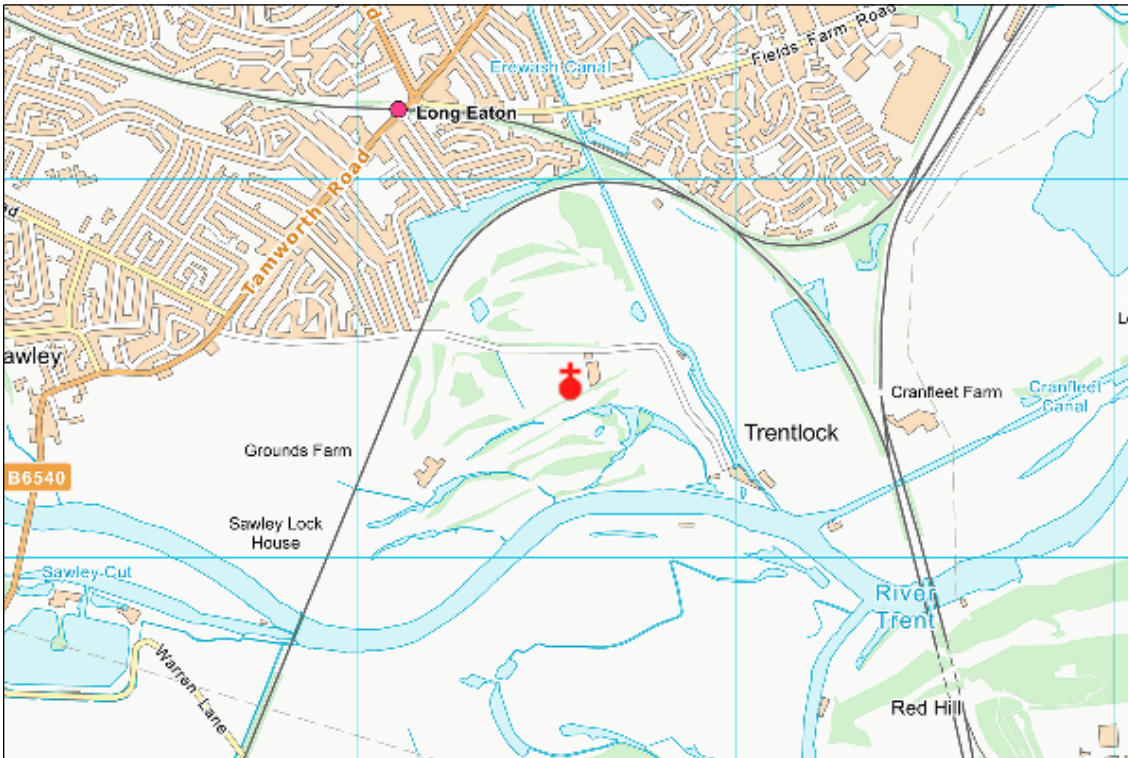

Grid Reference: SK 4855 3146

Unitary Authority: Derbyshire County

Previous QI Inspections

Date visited: 15/11/2018

Survey undertaken by: James Miles (Test)

QI Inspection

Date visited: 20/11/2018

Survey undertaken by: James Miles (Test)

Inspection summary:

Heading 1

Heading 2

This is where the Inspection text would go.

This is where the Inspection text would go with centre align

This is where the Inspection text would go with right align

This is what a [link](#) would look like

This is where the Inspection text would go with bold font



Caption: Window example



Caption: Window two



Caption: Image of the nave

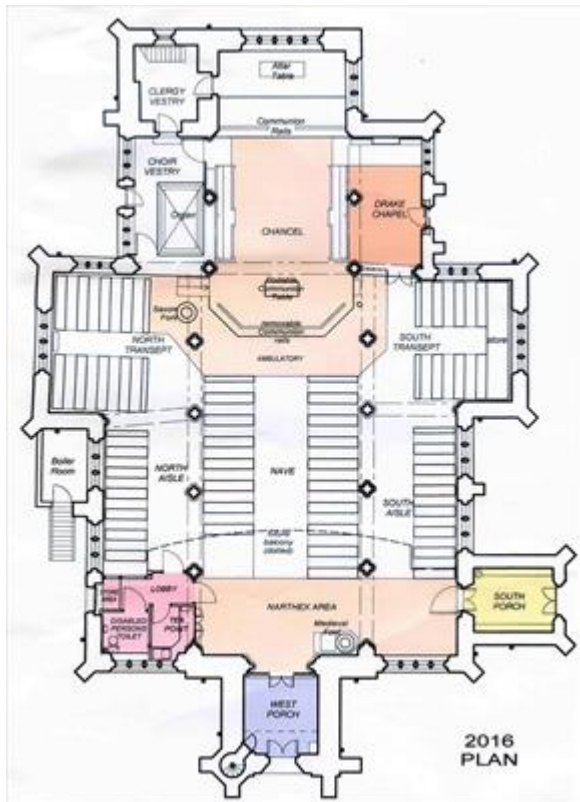

Caption: Plan of the church showing potential works

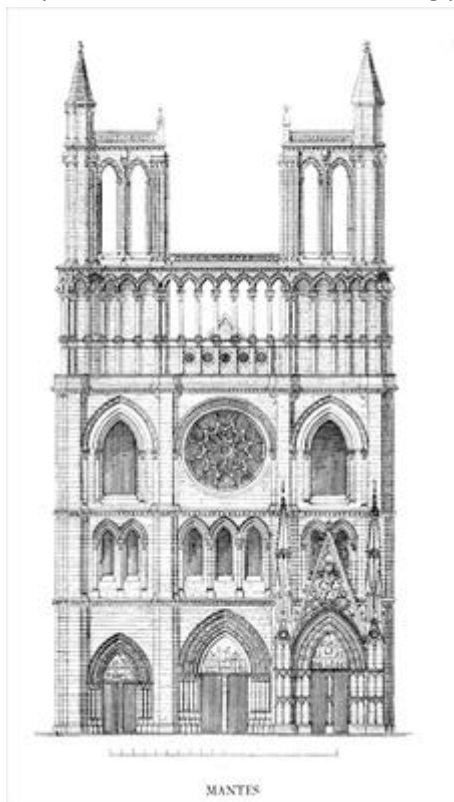

Caption: CAD drawing of west front elevation

Recommendations

Description of Works	Location of Works	Priority	Estimated Cost (£)
Stained glass window cracked	South Nave	Requires attention within the next 12 – 24 months	300
Roof leak	Aisle roof	Urgent, requiring immediate attention	10000
Tombstone leaning	Churchyard	Requires attention within 12 months	3000
Carpet is becoming frayed and has several spillages on it. Damage is too severe to fix and requires a replacement.	Chancel	Requires attention within the quinquennial period	2000