

## FORM 8 (Rule 7)

### Section 9 of Care of Cathedrals Measure 2011 Application to the Cathedrals Fabric Commission for approval of a proposal

To the Cathedrals Fabric Commission (“the Commission”)

**The Chapter of the Cathedral Church of:** *insert name of cathedral and contact details including telephone and email for the administrator or any other person dealing with the application*

The Cathedral Church of St Peter in Exeter:

Contact Details:

Alice Risdon,  
FAC Secretary and Project Administrator,  
No.1 The Cloisters,  
Exeter,  
Devon,  
EX1 1HS

Tel: 01392 285 983

Email: [alice.risdon@exeter-cathedral.org.uk](mailto:alice.risdon@exeter-cathedral.org.uk)

**applies to the Commission for approval of the following proposal:** *short description*

A programme of conservation works to priority windows in the East End:

- The Chapel of St John the Evangelist, East Window
- The Chapel of Sts. Saviours and Boniface, South Window
- The Lady Chapel, South Window to Bay 2
- The Chapel of St Gabriel, East Window
- The Chapel of St Gabriel, South Window.

**Summary of the nature of work and its extent (and materials) [or in the case of an object, a short description of it and details of the proposal]**

- Chapel of St John the Evangelist - East Window (work priority code 4D). Restore glass in the studio and reinstate within original glazing line, install an iso-thermal protective glazing system abutting the stone surround ventilating internally to the Cathedral.
- Chapel of Sts. Saviourius and Boniface - South Window (priority code 4D). Restoration of glass and local iso-thermal protection with stained glass brought into the cathedral.
- Chapel of Sts. Saviours and Boniface - East window (priority code 4D). Restoration of glass and local iso-thermal protection with stained glass brought into the cathedral.
- Lady Chapel - South Window to Bay 2 (priority code 3D). Restoration of glass and local iso-thermal protection with stained glass brought into the cathedral.
- Chapel of St. Gabriel - East window (priority code 4D). Restoration of glass and local iso-thermal protection with stained glass brought into the cathedral.
- Chapel of St. Gabriel - South Window (priority code 3C). In-situ cleaning, conservation and repair/improvement of sill detail.

**Plans, drawings, specifications or other documents**

**The proposal is described by the following items which accompany the form:**  
*List and number the items and give reference numbers, if applicable.*

R1-20\_083-40 CFCE Application Report

**DISPLAY OF PUBLIC NOTICE**

**I confirm that**

(i) a Public Notice in Form 9 is being displayed from the date of this application

(ii) a copy of the Public Notice in Form 9 is being sent immediately to the following bodies specified in rule 7(3) and (4) and as indicated below:

(iii) a copy (free of charge) of each of the plans, drawings, specifications or other documents itemised above is being sent immediately in accordance with rule 7(4) to the bodies indicated below.

*Indicate in boxes*

**Fabric Advisory Committee of the Cathedral**

**Historic England (formerly English Heritage)**

*[as applicable]*

**The following national amenity societies:**

- Ancient Monuments Society
- The Council for British Archaeology
- The Georgian Group
- The Society for the Protection of Ancient Buildings
- The Victorian Society
- The Twentieth Century Society

**Local Planning Authority** *only if the proposal is for works as described in section 2(1)(a) of the Measure*

**Signed:**



**Administrator on behalf of the Chapter**

**Dated: 28.09.2020**

## FORM 8 (Rule 7)

### Section 9 of Care of Cathedrals Measure 2011 Application to the Cathedrals Fabric Commission for approval of a proposal

To the Cathedrals Fabric Commission (“the Commission”)

**The Chapter of the Cathedral Church of:** *insert name of cathedral and contact details including telephone and email for the administrator or any other person dealing with the application*

**St. Peter and the Holy and Indivisible Trinity, Gloucester**

12 College Green, Gloucester GL1 2LX  
01452 508216

emily.mackenzie@gloucestercathedral.org.uk

**applies to the Commission for approval of the following proposal:** *short description*

New Liturgical Furniture in the Lady Chapel Sanctuary

**Summary of the nature of work and its extent (and materials) [or in the case of an object, a short description of it and details of the proposal]**

Create a new coherent set of Liturgical Furniture (Altar Table, base for the Lancut Font, Paschal Candle Stand and Lectern), to reside in the Sanctuary, behind the line of the Laudian Altar Rail. The design will be geometric, deferential to the interior of the chapel in oak and metal; the Altar Table will incorporate an element of carved lettering, partly as a memorial to the late Bishop, Michael Perham. The existing furniture will be retained within the Cathedral red line.

**Plans, drawings, specifications or other documents**

**The proposal is described by the following items which accompany the form:**

*List and number the items and give reference numbers, if applicable.*

1048-6066 - GlosCath Lady Chapel new liturgical furniture - PHOTOMONTAGE - 2020-08-20  
1048-6066 GlosCath LadyChpl New liturgical furniture DESIGN PROPOSAL 2020-08-19  
1048-6066-302-A Existing sanctuary floor plan  
1048-6066-303-A\_Proposed sanctuary floor plan  
1048-6066-305-A\_Proposed east end elevation  
1048-6066-306-A\_Proposed sanctuary altar table  
1048-6066-307\_Proposed font-lectern-candle details  
Gloucester Cathedral Liturgical Plan June 2020 revision  
Letter to CFCE Lady Chapel furniture September 2020

**DISPLAY OF PUBLIC NOTICE**

**I confirm that**

(i) a Public Notice in Form 9 is being displayed from the date of this application

(ii) a copy of the Public Notice in Form 9 is being sent immediately to the following bodies specified in rule 7(3) and (4) and as indicated below:

(iii) a copy (free of charge) of each of the plans, drawings, specifications or other documents itemised above is being sent immediately in accordance with rule 7(4) to the bodies indicated below.

*Indicate in boxes*

**Fabric Advisory Committee of the Cathedral**

**Historic England (formerly English Heritage)**

*[as applicable]*

**The following national amenity societies:**

- Ancient Monuments Society
- The Council for British Archaeology
- The Georgian Group
- The Society for the Protection of Ancient Buildings
- The Victorian Society
- The Twentieth Century Society

**Local Planning Authority** *only if the proposal is for works as described in section 2(1)(a) of the Measure*

**Signed:**



**Administrator on behalf of the Chapter**

**Dated:**

*02/09/20*

## FORM 8 (Rule 7)

### Section 9 of Care of Cathedrals Measure 2011 Application to the Cathedrals Fabric Commission for approval of a proposal

To the Cathedrals Fabric Commission (“the Commission”)

**The Chapter of the Cathedral Church of:** *insert name of cathedral and contact details including telephone and email for the administrator or any other person dealing with the application*

The Holy & Undivided Trinity of Norwich  
Chapter Office  
65 The Close  
Norwich NR1 4DH  
Phil Thomas, Estates Manager: 01603 218307 [pthomas@cathedral.org.uk](mailto:pthomas@cathedral.org.uk)

**applies to the Commission for approval of the following proposal:** *short description*

Norwich School propose to make alterations to secure the boundary around the Upper School Site

**Summary of the nature of work and its extent (and materials) [or in the case of an object, a short description of it and details of the proposal]**

Norwich School wish to secure the boundary to the Upper School following recommendations about child protection and safeguarding from the Independent Schools Inspectorate. This inspection highlighted the ease of access to the site and lack of segregation between vehicles and pupils. As a consequence, the school is proposing to increase security at existing entrances, raise some railings and install new sections, and re-establish a former entrance for pedestrians close to 69 the Close. The latter will require steps so there is some excavation required. The existing gates to both the playground and Bishop’s Palace will be automated so they can remain closed except for the passage of authorised vehicles. In order to assist the circulation of pupils within the site, it is also proposed to make a new pedestrian opening in the wall between the playground and Bishop’s Palace area. The application was considered by FAC (24/7/20) and follows their recommended amendments.

**Plans, drawings, specifications or other documents**

**The proposal is described by the following items which accompany the form:**

*List and number the items and give reference numbers, if applicable.*

- Statement of Justification by Norwich School V6
- Archaeological Assessment by Dr Roland Harris
- S1.1 Location JAS134 Fence app-10
- S1.2 Site Plan JAS134 Fence app-20
- S2.1 HF existing 20.001-51
- S2.2 HF proposed 20.001 RevA-51
- S2.3 JAS134 Fence app- 25REVB
- S2.4 JAS134 Fence app- 26
- S3.1 JAS134 Fence app- 28REVA
- S4.1 JAS134 Fence app- 27
- S5.1 HF Existing and Proposed 20.079
- S5.2 Entry Control technical details

**DISPLAY OF PUBLIC NOTICE**

**I confirm that**

- (i) a Public Notice in Form 9 is being displayed from the date of this application
- (ii) a copy of the Public Notice in Form 9 is being sent immediately to the following bodies specified in rule 7(3) and (4) and as indicated below:
- (iii) a copy (free of charge) of each of the plans, drawings, specifications or other documents itemised above is being sent immediately in accordance with rule 7(4) to the bodies indicated below.

*Indicate in boxes*

**Fabric Advisory Committee of the Cathedral**

**Historic England (formerly English Heritage)**

*[as applicable]*

**The following national amenity societies:**

- Ancient Monuments Society
- The Council for British Archaeology
- The Georgian Group
- The Society for the Protection of Ancient Buildings
- The Victorian Society
- The Twentieth Century Society

**Local Planning Authority** *only if the proposal is for works as described in section 2(1)(a) of the Measure*

**Signed:**

**Administrator on behalf of the Chapter**

**Dated:**

## FORM 8 (Rule 7)

### Section 8 of Care of Cathedrals Measure 1990 (as amended)

### Application to the Cathedrals Fabric Commission for approval of a proposal

To the Cathedrals Fabric Commission (“the Commission”)

The Chapter of the Cathedral Church of:

*Insert name of cathedral.*

NORWICH

*Insert full postal address and contact telephone and fax numbers and e-mail address.*

Postal address, including postcode of the administrator or any other person dealing with the application:

THE CHAPTER OFFICE  
65 THE CLOSE  
NORWICH  
NR1 4DH

Telephone number: 01603 218300

E-mail address: [chaptersteward@cathedral.org.uk](mailto:chaptersteward@cathedral.org.uk)

**applies to the Commission for approval of the following proposal:**

*Short description e.g. repair of stonework, sale of silver.*

#### **The Proposal**

To install a wooden crucifix in the south east corner of the east Cloister Walk.

#### **Summary of the nature of the work and its extent (and materials) [or in the case of an object, a short description of it and details of the proposal]**

To install a wooden crucifix in the first bay of the south east corner of the east Cloister Walk. The crucifix would be hung utilising fixings drilled into mortar joints.

#### **Plans, drawings, specifications or other documents**

**The proposal is described by the following items which accompany this form:**

*List and number the items and give reference numbers, if applicable.*

1. Details of crucifix
2. Plan of Cloister detailing proposed location of crucifix
3. Super imposed image of crucifix in the Cloister





**DISPLAY OF PUBLIC NOTICE**

**I confirm that**

- (i) a Public Notice in Form 9 is being displayed from the date of this application;
- (ii) a copy of the Public Notice in Form 9 is being sent immediately to the following bodies specified in rule 7(3) and (4) and as indicated below;
- (iii) a copy (free of charge) of each of the plans, drawings, specifications or other documents itemised above is being sent immediately in accordance with rule 7(4) to the bodies indicated below.

**Public Notice**

*Tick boxes to indicate.*

**Fabric Advisory Committee of the Cathedral**

**Copy plans etc.**

**English Heritage**

*\* If none, then notice is to be given to each amenity society listed below.*

**The national amenity societies (or such person\* as those societies have jointly appointed for the purposes of the Measure)**

If the proposal is for works described in section 2(1)(a) of the Measure—

**Local Planning Authority**

*Neil Parsons*  
**Signed: NEIL PARSONS – CHAPTER STEWARD**

**Administrator on behalf of the Chapter**

**Dated: 28 August 2020**

**Notes**

1. The national amenity societies are the Ancient Monuments Society, the Council for British Archaeology, the Georgian Group, the Society for the Protection of Ancient Buildings, the Victorian Society and the Twentieth Century Society.
2. This form and all the accompanying items in it should be sent to the secretary of the Cathedrals Fabric Commission at the Commission's published address.

## Cloister Crucifix Proposal



The image is the work of the French religious community known as *The Monastic Family of Bethlehem of the Assumption of the Virgin and of St Bruno*. Much of their work is done in this characteristically Romanesque style. The website states:

<https://translate.google.co.uk/translate?hl=en&sl=fr&u=https://www.bethleem.org/&prev=search>

*The craft of the monks and nuns is not only the means of earning the daily bread of each monastery but also a service of Church. This Christian art wants to be an expression of faith, an unveiling of the Mystery of God which is Beauty and Goodness, and into which man is called to enter. Religious crafts such as icons, statues, medals, chalices, incense, etc. and crafts of profane objects such as hand-painted stoneware or earthenware, candles, sandals, cookies, etc... are carried out in the workshops of the monasteries according to the skills of each. Far from breaking the momentum of prayer, this work accomplished in toil and fatigue, purifies the heart and intensifies union with God as well as communion with the men and women of the whole world who toil to feed their families. These works of art are content to sing the Invisible. Their goal is achieved if those who contemplate them are carried beyond themselves in a certain silence of worship.*

The community makes crucifixes in many sizes, some with crosses and some without, but this is the only one they make that would be large enough (1.85m. 6 ft) for its setting in the Cloisters.

Based on HBRU survey drawing 1998\_Level101.dwg

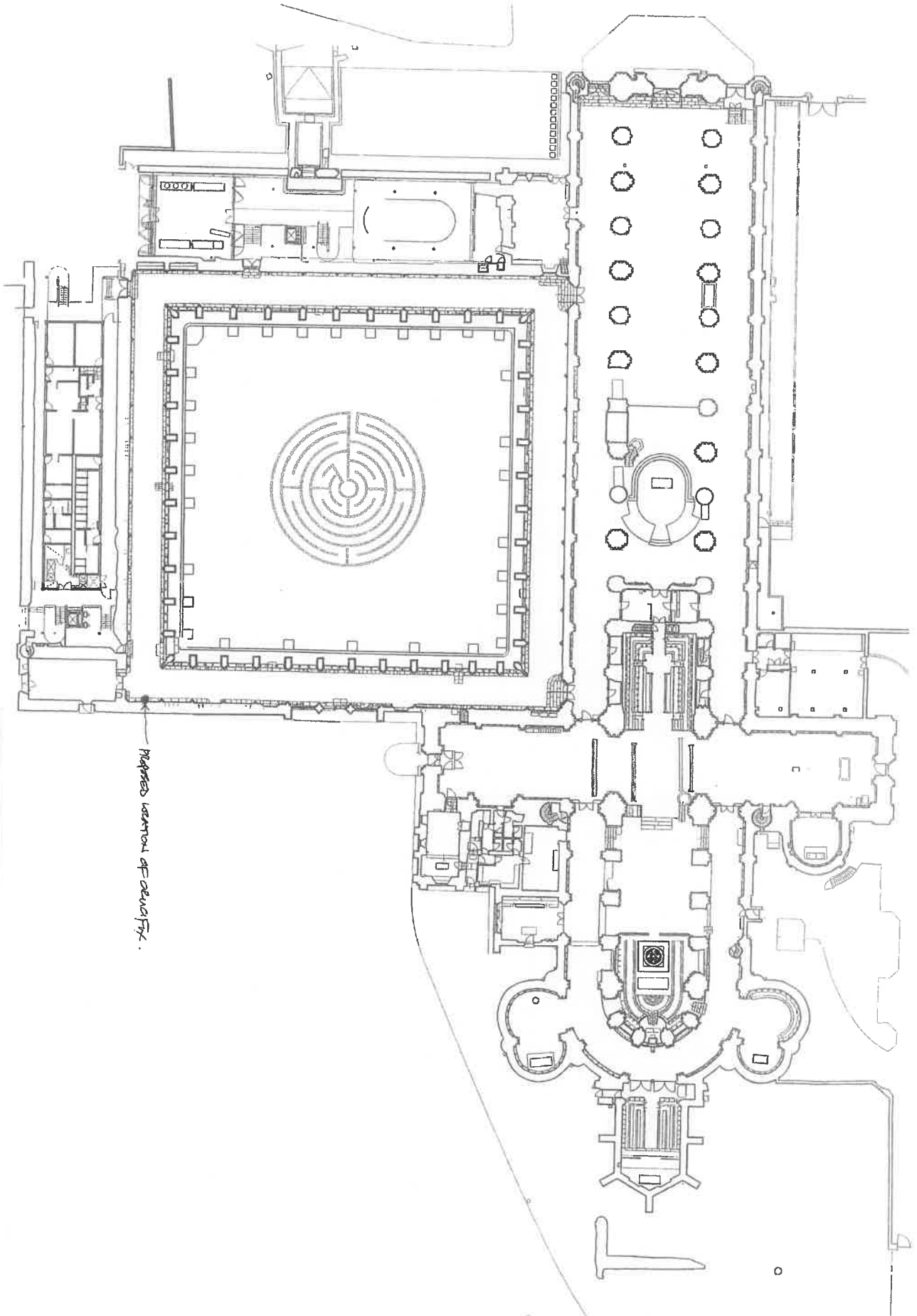

**NORWICH CATHEDRAL**  
 CONSERVATION MANAGEMENT PLAN FOR NORWICH CATHEDRAL

**GROUND (LEVEL 1)**

8.2 | 1

Drawing title		Project name		Date		Revision number	
PLAN: LOCATION		THE CATHEDRAL OF NORWICH CATHEDRAL		20.07.11		1	
Job title		Client		Drawn by		Checked by	
PLANNING IN SUPPORT		NHS		HF		MS	
FRELAND REES ROBERTS ARCHITECTS		100 Brook Road, Cambridge, CB1 1DP		01223 513260		01223 513260	

© Freeland Rees Roberts Limited. Company No. 5194770



## FORM 8 (Rule 7)

### Section 9 of Care of Cathedrals Measure 2011 Application to the Cathedrals Fabric Commission for approval of a proposal

To the Cathedrals Fabric Commission (“the Commission”)

**The Chapter of the Cathedral Church of:** *insert name of cathedral and contact details including telephone and email for the administrator or any other person dealing with the application*

St Saviour and St Mary Overie, Southwark,  
Contact details: Matthew Knight, Comptroller  
Tel: 020 7367 6726  
Email: matthew.knight@southwark.anglican.org

**applies to the Commission for approval of the following proposal:** *short description*

Access improvements to create step-free access to all ground level parts of the Cathedral church

**Summary of the nature of work and its extent (and materials) [or in the case of an object, a short description of it and details of the proposal]**

**Project 1A:** Access from the nave to the north transept - It is proposed that the existing York stone floor slabs be lowered to form a ramp which will provide step-free access between nave and transept.

**Project 1B:** Access from the nave to the south transept - Following removal of the existing non-compliant ramp, it is proposed that the existing York stone floor be lowered to construct a ramp which will provide step-free access from nave to transept.

**Project 1C:** Access to the south choir aisle from the south transept - installation of a chair lift.

**Project 4A:** Access to the retrochoir from the north choir aisle - A new ramp is proposed to the north of the existing double gate opening.

**Project 4B:** Access to the retrochoir from the south choir aisle - It is proposed to upgrade the existing ramp to provide kerbs and handrails to either side.

**Plans, drawings, specifications or other documents**

**The proposal is described by the following items which accompany the form:**

*List and number the items and give reference numbers, if applicable.*

Southwark Cathedral Access Report V2 September 2020

**DISPLAY OF PUBLIC NOTICE**

**I confirm that**

(i) a Public Notice in Form 9 is being displayed from the date of this application

(ii) a copy of the Public Notice in Form 9 is being sent immediately to the following bodies specified in rule 7(3) and (4) and as indicated below:

(iii) a copy (free of charge) of each of the plans, drawings, specifications or other documents itemised above is being sent immediately in accordance with rule 7(4) to the bodies indicated below.

*Indicate in boxes*

**Fabric Advisory Committee of the Cathedral**

**Historic England (formerly English Heritage)**

*[as applicable]*

**The following national amenity societies:**

- Ancient Monuments Society
- The Council for British Archaeology
- The Georgian Group
- The Society for the Protection of Ancient Buildings
- The Victorian Society
- The Twentieth Century Society

n/a

**Local Planning Authority** *only if the proposal is for works as described in section 2(1)(a) of the Measure*



**Signed:**

**Administrator on behalf of the Chapter**

**Dated: 4 September 2020**