

FORM 8 (Rule 7)

Section 9 of Care of Cathedrals Measure 2011 Application to the Cathedrals Fabric Commission for approval of a proposal

To the Cathedrals Fabric Commission (“the Commission”)

The Chapter of the Cathedral Church of: *insert name of cathedral and contact details including telephone and email for the administrator or any other person dealing with the application*

Christ Canterbury, Cathedral House, 11 The Precincts, Canterbury, Kent CT1 2EH
N.Beldin, Estate Surveyor 01227 862740
natalie.beldin@canterbury-cathedral.org

applies to the Commission for approval of the following proposal: *short description*

Groundworks comprising the excavation of existing service trenches in the area immediately to the east of Marlowe House (21 The Precincts), and the excavation of new trenches within the building to create drainage connections.

Summary of the nature of work and its extent (and materials) [or in the case of an object, a short description of it and details of the proposal]

The nature of the work is to replace defective drainage in existing service trenches externally and create new drainage connections within the building.

Plans, drawings, specifications or other documents

The proposal is described by the following items which accompany the form:

List and number the items and give reference numbers, if applicable.

1. 2106-01 Site Location Plan
2. Report 2021/95 Heritage Impact Assessment
3. 2106-40A Proposed below ground drainage plan
4. Scheduled monument consent dated 12/7/21

DISPLAY OF PUBLIC NOTICE

I confirm that

(i) a Public Notice in Form 9 is being displayed from the date of this application

(ii) a copy of the Public Notice in Form 9 is being sent immediately to the following bodies specified in rule 7(3) and (4) and as indicated below:

(iii) a copy (free of charge) of each of the plans, drawings, specifications or other documents itemised above is being sent immediately in accordance with rule 7(4) to the bodies indicated below.

Indicate in boxes

☐

Fabric Advisory Committee of the Cathedral

☐

Historic England (formerly English Heritage)

[as applicable]

☐

The following national amenity societies:

- Ancient Monuments Society
- The Council for British Archaeology
- The Georgian Group
- The Society for the Protection of Ancient Buildings
- The Victorian Society
- The Twentieth Century Society

☐

Local Planning Authority *only if the proposal is for works as described in section 2(1)(a) of the Measure*

Signed:

Administrator on behalf of the Chapter

Dated: 28th July 2021

FORM 8 (Rule 7)

Section 8 of Care of Cathedrals Measure 1990 (as amended)

Application to the Cathedrals Fabric Commission for approval of a proposal

To the Cathedrals Fabric Commission (“the Commission”)

The Chapter of the Cathedral Church of:

Insert name of cathedral.

The Holy Trinity, CHICHESTER

Insert full postal address and contact telephone and fax numbers and e-mail address.

Postal address, including postcode of the administrator or any other person dealing with the application:

The Communar
The Royal Chantry, Cathedral Cloisters
CHICHESTER, West Sussex PO19 1PX

Telephone number: 01243 812489

Fax number: 01243 812499

E-mail address: communar@chichestercathedral.org.uk

applies to the Commission for approval of the following proposal:

Short description e.g. repair of stonework, sale of silver.

The Proposal

To revise the setting of the Cathedral font to address health and safety issues and to improve accessibility and liturgical function.

Summary of the nature of the work and its extent (and materials) [or in the case of an object, a short description of it and details of the proposal]

The Cathedral font, designed and created by John Skelton, installed in 1983, currently sits on a single step plinth which has been a trip hazard to the visiting public. Throughout much of its life the font has been roped off or had access otherwise impaired. It also functions imperfectly as a liturgical feature during baptisms due to the step plinth.

The proposal is to remove the plinth and lower the font to floor level. A visual ‘echo’ of the removed plinth will be created around the font set flush with the surrounding floor. This will include the use of existing black slate plus pale Purbeck and a darker grey Purbeck, bedded and pointed using a lime-based mortar on top of a new 200mm concrete slab to spread the load of the font.

The attached proposals for both lowering and the addition of a drain were the product of much deliberation and feedback, including input from CFCE delegation members when they visited in 2019. However, the FAC considered the implications and potential methodology for adding a drain and concluded that this was too high risk an intervention.

Plans, drawings, specifications or other documents

The proposal is described by the following items which accompany this form:

List and number the items and give reference numbers, if applicable.

1. Cathedral Font (revisions to setting) Proposal document – July 2020
2. Cathedral Plan – Baptistry highlighted
3. Existing South West Tower plan
4. Proposed South West Tower plan
5. Existing Font plan and elevation
6. Proposed Font plan and section
7. Excerpt of Chapter Minutes approving the proposal
8. CFCE Post-visit advice letter 20Dec'19

DISPLAY OF PUBLIC NOTICE

I confirm that

- (i) a Public Notice in Form 9 is being displayed from the date of this application;
- (ii) a copy of the Public Notice in Form 9 is being sent immediately to the following bodies specified in rule 7(3) and (4) and as indicated below;
- (iii) a copy (free of charge) of each of the plans, drawings, specifications or other documents itemised above is being sent immediately in accordance with rule 7(4) to the bodies indicated below.

Public Notice

Tick boxes to indicate.

☒

Fabric Advisory Committee of the Cathedral

Copy plans etc.

☒

English Heritage

☒

** If none, then notice is to be given to each amenity society listed below.*

☒

The national amenity societies (or such person* as those societies have jointly appointed for the purposes of the Measure)

☒

If the proposal is for works described in section 2(1)(a) of the Measure—

☐

Local Planning Authority

☐

Signed:

Communar

Dated: 07/07/2021

Notes

1. The national amenity societies are the Ancient Monuments Society, the Council for British Archaeology, the Georgian Group, the Society for the Protection of Ancient Buildings, the Victorian Society and the Twentieth Century Society.
2. This form and all the accompanying items in it should be sent to the secretary of the Cathedrals Fabric Commission at the Commission's published address.

FORM 8 (Rule 7)

Section 8 of Care of Cathedrals Measure 1990 (as amended)

Application to the Cathedrals Fabric Commission for approval of a proposal

To the Cathedrals Fabric Commission (“the Commission”)

The Chapter of the Cathedral Church of:

Insert name of cathedral.

The Holy Trinity, CHICHESTER

Insert full postal address and contact telephone and fax numbers and e-mail address.

Postal address, including postcode of the administrator or any other person dealing with the application:

The Communar
The Royal Chantry, Cathedral Cloisters
CHICHESTER, West Sussex PO19 1PX

Telephone number: 01243 812489

Fax number: 01243 812499

E-mail address: communar@chichestercathedral.org.uk

applies to the Commission for approval of the following proposal:

Short description e.g. repair of stonework, sale of silver.

A new Cathedral lighting scheme to replace the outdated existing internal lighting - which is at the end of its serviceable life - with new, low-energy lighting that provides suitable illumination for congregation, celebrants, visitors and event attendees, as well as properly presenting the building’s historic architecture. The adaptable lighting will support the Cathedral’s Liturgical Plan, and facilitate the desired range of liturgical and other uses for the various spaces of the Cathedral interior and cloisters, whilst also being less visually intrusive than the current fittings.

The project is important to support progress towards the Cathedral’s Net Zero 2030 target, to which the current energy-hungry lighting is a significant barrier; to improve the experience of the Cathedral for worshippers and visitors; and because the current lighting is in need of replacement, with components becoming increasingly difficult to source.

.....
Summary of the nature of the work and its extent (and materials) [or in the case of an object, a short description of it and details of proposal]

Key elements are:

- Task lighting from high – typically clerestory - level heading across and down;
- Light levels that can be managed by Cathedral staff, dimmable and fully programmable, general principle that levels should be kept low;
- Accent lighting to be used for key features and liturgical locations;
- Architectural uplighting from clerestory into vault, and of triforium and nave arcading;

- Downlights in aisles to make floors more visible;
- Aisle uplights into vaults;
- Baptistry and side chapels to receive highlight lighting and spotlighting, also retro-choir and Shrine, highlighting altar and icon;
- Quire and Presbytery - uplighting into vault and triforium arches, with downlighting provided from spotlights at high level; choir stall lights to be removed; oil-filled candelabra to remain;
- Lady Chapel - Pendants raised slightly with new electronic candles installed for improved downlighting; Highlight lighting from replacement spotlights at window reveals for altar, reredos and lectern;
- New uplighting at Arundel Screen that will allow 75% of existing glazed apertures to be replaced with stone infills;
- The removal of the Nave Pendants.

The fundamental requirement is to create suitable reading light for all areas of the congregation and for celebrants, providing suitable light to the key points of liturgical focus within an ambience that is appropriate to the building interior – and cloisters - as a whole.

The proposals have been developed by Bruce Kirk / Light Perceptions in conjunction with Cathedral Clergy and Surveyor of the Fabric, and follow feedback and learning from demonstrations to Cathedral / Cathedral Friends representatives and to the Chichester Fabric Advisory Committee and a delegation from the Cathedrals Fabric Commission in November 2019.

.....

Plans, drawings, specifications or other documents

The proposal is described by the following items which accompany this form:

List and number the items and give reference numbers, if applicable.

1. Design Statement, December 2020
2. Lighting Design Concept Report
3. Liturgical Plan
4. CFCE delegation post-visit advice letter
5. CFCE lighting advice letter
6. Excerpt of Chapter Minutes
7. Low Level Lighting Drawing
8. Triforium Level Lighting Drawing
9. Clerestory Level Lighting Drawing
10. Luminaire Schedule
11. Luminaire Datasheets

DISPLAY OF PUBLIC NOTICE

I confirm that

- (i) a Public Notice in Form 9 is being displayed from the date of this application;
- (ii) a copy of the Public Notice in Form 9 is being sent immediately to the following bodies specified in rule 7(3) and (4) and as indicated below;
- (iii) a copy (free of charge) of each of the plans, drawings, specifications or other documents itemised above is being sent immediately in accordance with rule 7(4) to the bodies indicated below.

Public Notice

Tick boxes to indicate.

☒

Fabric Advisory Committee of the Cathedral

Copy plans etc.

☒

English Heritage

☒

** If none, then notice is to be given to each amenity society listed below.*

☒

The national amenity societies (or such person* as those societies have jointly appointed for the purposes of the Measure)

☒

If the proposal is for works described in section 2(1)(a) of the Measure—

☐

Local Planning Authority

☐

Signed:

Communar

Dated: 07/07/2021

Notes

1. The national amenity societies are the Ancient Monuments Society, the Council for British Archaeology, the Georgian Group, the Society for the Protection of Ancient Buildings, the Victorian Society and the Twentieth Century Society.
2. This form and all the accompanying items in it should be sent to the secretary of the Cathedrals Fabric Commission at the Commission's published address.

FORM 8 (Rule 7)

Section 9 of Care of Cathedrals Measure 2011 Application to the Cathedrals Fabric Commission for approval of a proposal

To the Cathedrals Fabric Commission (“the Commission”)

The Chapter of the Cathedral Church of: *insert name of cathedral and contact details including telephone and email for the administrator or any other person dealing with the application*

The Cathedral Church of Christ, Blessed Mary the Virgin and St Cuthbert of Durham,
The Cathedral Office, The College, Durham Dh1 3EH

Garry Haines, Governance and Compliance Manager and Deputy Chapter Clerk

Tel: 0191 338 7146

Email: garry.haynes@durhamcathedral.co.uk

applies to the Commission for approval of the following proposal: *short description*

Rebuild the collapsed boundary wall at St Mary the Less Church as per Structural Engineer's proposed drawings.

Summary of the nature of work and its extent (and materials) [or in the case of an object, a short description of it and details of the proposal]

The wall will be re-built like-for-like using traditional masonry techniques and tying in with the parts of the wall still standing. The following small changes will be made to improve the new wall's weathering capacities:

- the off-set towards the top of the historic wall will be replicated but in stooped ashlar to prevent vegetation taking root;
- improved ground drainage to the rear of the tall retaining wall will be included.

A small amount of new stone work will be needed as some of the original stone may not be viable to reuse as facing stone but will be used as infill. Such stone will be sourced from reclaimed local sandstone. All copings as well as the improved off-set string course will have to be carried out in new stonework.

The Cathedral's Works Yard will lead the work which will include matching stone in liaison with the Cathedral Architect.

The boundary wall falls within the 'Green Line' under Cathedral Measure, is listed Grade II in its own right as part of the adjacent 'Parsonage' (list entry number 1121336) and falls into the curtilage of the adjacent Grade II listed Church of St Mary-the-Less. In addition to CFCE approval, we will seek Listed Building Consent and Faculty for the works.

Plans, drawings, specifications or other documents

The proposal is described by the following items which accompany the form:

List and number the items and give reference numbers, if applicable.

Reports to FAC 10 June 2021 meeting including:

1. Paper I -Report to FAC 10 Jun 2021 Collapsed Wall St. Mary the Less
2. Paper I - Appendix A - Report to FAC June 2019 Collapsed Wall St Mary the Less (background information)
3. Paper I - Appendix B - Report to FAC 5 Nov 2020 Collapsed Boundary Wall to St. Mary the Less - Archaeological Investigations.
4. Paper I - Appendix C - Report to FAC 10 Jun 2021 Collapsed Boundary Wall to St. Mary the Less - Structural Engineer Report.
5. **Paper I -Appendix D Report to FAC 10 Jun 2021 Collapsed Wall St. Mary the Less Structural Engineer Existing & Proposed Drawings**

DISPLAY OF PUBLIC NOTICE

I confirm that

- (i) a Public Notice in Form 9 is being displayed from the date of this application
- (ii) a copy of the Public Notice in Form 9 is being sent immediately to the following bodies specified in rule 7(3) and (4) and as indicated below:
- (iii) a copy (free of charge) of each of the plans, drawings, specifications or other documents itemised above is being sent immediately in accordance with rule 7(4) to the bodies indicated below.

Indicate in boxes

☒

Fabric Advisory Committee of the Cathedral

☐

Historic England (formerly English Heritage)

[as applicable]

☐

The following national amenity societies:

- Ancient Monuments Society
- The Council for British Archaeology
- The Georgian Group
- The Society for the Protection of Ancient Buildings
- The Victorian Society
- The Twentieth Century Society

☒

Local Planning Authority *only if the proposal is for works as described in section 2(1)(a) of the Measure*

Signed:

Administrator on behalf of the Chapter

Dated: 15.07.2021

FORM 8 (Rule 7)

Section 9 of Care of Cathedrals Measure 2011 Application to the Cathedrals Fabric Commission for approval of a proposal

To the Cathedrals Fabric Commission (“the Commission”)

The Chapter of the Cathedral Church of:

St Peter in Exeter

applies to the Commission for approval of the following proposal:

Retrospective approval is sought for the repair works to Monuments 115 (James Bell) and 116 (Richard Hereford), carried out due to the significant H&S risk posed by the deterioration in their condition.

Summary of the nature of work and its extent (and materials) [or in the case of an object, a short description of it and details of the proposal]

Monument 115: replacement of the rusting iron fixings with a new stainless-steel cramp and pins.
Repairs to tablet and figure.
Monument 116: replacement of the rusting iron fixings with a new stainless-steel cramp and pins.
Repairs to the tablet.

Plans, drawings, specifications or other documents

The proposal is described by the following items which accompany the form:

R14 Monuments No 115 and 116 - Exeter Compressed.pdf

DISPLAY OF PUBLIC NOTICE

I confirm that

(i) a Public Notice in Form 9 is being displayed from the date of this application

(ii) a copy of the Public Notice in Form 9 is being sent immediately to the following bodies specified in rule 7(3) and (4) and as indicated below:

(iii) a copy (free of charge) of each of the plans, drawings, specifications or other documents itemised above is being sent immediately in accordance with rule 7(4) to the bodies indicated below.

Indicate in boxes

☐

Fabric Advisory Committee of the Cathedral

☐

Historic England (formerly English Heritage)

[as applicable]

☐

The following national amenity societies:

- The Society for the Protection of Ancient Buildings
- The Victorian Society
- The Twentieth Century Society

☐

Local Planning Authority

Signed: A. Risdon, Secretary to the FAC

On behalf of C. Escott Administrator on behalf of the Chapter

Dated:14.07.2021

FORM 8 (Rule 7)

Section 9 of Care of Cathedrals Measure 2011 Application to the Cathedrals Fabric Commission for approval of a proposal

To the Cathedrals Fabric Commission (“the Commission”)

The Chapter of the Cathedral Church of:

St Peter in Exeter

Contact Details:

Alice Risdon

FAC Secretary and Project Administrator,

No.1 The Cloisters,

Exeter,

Devon,

EX1 1JS

Tel: 01392 285 983

Email: Alice.risdon@exeter-cathedral.org.uk

applies to the Commission for approval of the following proposal:

Chapter House ceiling conservation works.

Summary of the nature of work and its extent (and materials) [or in the case of an object, a short description of it and details of the proposal]

A programme of works to clean, conserve and repair the timber painted ceiling in the Chapter House. Permission is sought for the full scheme across all four bays, although the works will likely be undertaken in two phases. Details of the proposals can be found in the relevant reports, listed below.

Plans, drawings, specifications or other documents

The proposal is described by the following items which accompany the form:

R1-21_063-34 Chapter House Ceiling - CFCE - Grant Application (Appendices)

DISPLAY OF PUBLIC NOTICE

I confirm that

(i) a Public Notice in Form 9 is being displayed from the date of this application

(ii) a copy of the Public Notice in Form 9 is being sent immediately to the following bodies specified in rule 7(3) and (4) and as indicated below:

(iii) a copy (free of charge) of each of the plans, drawings, specifications or other documents itemised above is being sent immediately in accordance with rule 7(4) to the bodies indicated below.

Indicate in boxes

☐

Fabric Advisory Committee of the Cathedral

☐

Historic England (formerly English Heritage)

[as applicable]

☐

The following national amenity societies:

- The Society for the Protection of Ancient Buildings
- The Victorian Society
- The Twentieth Century Society

☐

Local Planning Authority *only if the proposal is for works as described in section 2(1)(a) of the Measure*

Signed: A. Risdon, FAC Secretary

Administrator on behalf of the Chapter

Dated: 16.07.2021

FORM 8 (Rule 7)

Section 9 of Care of Cathedrals Measure 2011 Application to the Cathedrals Fabric Commission for approval of a proposal

To the Cathedrals Fabric Commission (“the Commission”)

The Chapter of the Cathedral Church of:

St Peter in Exeter

Contact Details:

Alice Risdon

FAC Secretary and Project Administrator,

No.1 The Cloisters,

Exeter,

Devon,

EX1 1JS

Tel: 01392 285 983

Email: Alice.risdon@exeter-cathedral.org.uk

applies to the Commission for approval of the following proposal:

Phase 2 of a programme of works to conserve and protect stained glass at Exeter Cathedral.

Summary of the nature of work and its extent (and materials) [or in the case of an object, a short description of it and details of the proposal]

The installation of partial environmental protection to stained glass panels in the Lady Chapel and medieval fragments in Oldham's Passage and a full scheme of environmental protective glazing to the Peckitt windows of the Pearson Cloister Building together with the restoration of associated leaded lights.

Plans, drawings, specifications or other documents

The proposal is described by the following items which accompany the form:

R1-21_061-32 Windows Phase 2 - Grant Application - CFCE (Appendices)

DISPLAY OF PUBLIC NOTICE

I confirm that

(i) a Public Notice in Form 9 is being displayed from the date of this application

(ii) a copy of the Public Notice in Form 9 is being sent immediately to the following bodies specified in rule 7(3) and (4) and as indicated below:

(iii) a copy (free of charge) of each of the plans, drawings, specifications or other documents itemised above is being sent immediately in accordance with rule 7(4) to the bodies indicated below.

Indicate in boxes

☐

Fabric Advisory Committee of the Cathedral

☐

Historic England (formerly English Heritage)

[as applicable]

☐

The following national amenity societies:

- Ancient Monuments Society
- The Council for British Archaeology
- The Georgian Group
- The Society for the Protection of Ancient Buildings
- The Victorian Society
- The Twentieth Century Society

☐

Local Planning Authority *only if the proposal is for works as described in section 2(1)(a) of the Measure*

Signed: A. Risdon, FAC Secretary

Administrator on behalf of the Chapter

Dated: 16.07.2021

FORM 8 (Rule 7)

Section 9 of Care of Cathedrals Measure 2011 Application to the Cathedrals Fabric Commission for approval of a proposal

To the Cathedrals Fabric Commission (“the Commission”)

The Chapter of the Cathedral Church of: *insert name of cathedral and contact details including telephone and email for the administrator or any other person dealing with the application*

St. Peter and the Holy and Indivisible Trinity, Gloucester

12 College Green, Gloucester GL1 2LX
01452 508216

emily.mackenzie@gloucestercathedral.org.uk

applies to the Commission for approval of the following proposal: *short description*

Organ re-build

Summary of the nature of work and its extent (and materials) [or in the case of an object, a short description of it and details of the proposal]

The proposal is for a tonal ensemble of five manual divisions (Chaire, Great, Nave, Swell and Solo) and Pedal. Save for the retention of the surviving Harris pipework and a few other items (material by Bishop and Willis), all pipework will be new. All of the organ mechanism will be new, with electro-pneumatic action throughout. The organ will as now be housed primarily within the existing cases, with pedal basses in the adjacent screen chamber. A new console will be provided on the screen. This will be moveable to any location on the south side of the case, subject to a flat floor being provided.

The existing seventeenth-century casework and façade pipes will not be altered in any way.

Plans, drawings, specifications or other documents

The proposal is described by the following items which accompany the form:
List and number the items and give reference numbers, if applicable.

Gloucester Cathedral - organ proposal May 2021
Gloucester Cathedral Organ 2020 Towards a Revised Tonal Design revised 31 October 2020
Gloucester Cathedral Organ 2020, a Statement of Need revised 19 November 2020
Gloucester Cathedral Organ 2020, a Statement of Significance, revised 19 November 2020
Gloucester Cathedral Liturgical Plan June 2020 revision
Letter to CFCE Organ Application - July 2021 Gloucester Cathedral

DISPLAY OF PUBLIC NOTICE

I confirm that

- (i) a Public Notice in Form 9 is being displayed from the date of this application
- (ii) a copy of the Public Notice in Form 9 is being sent immediately to the following bodies specified in rule 7(3) and (4) and as indicated below:
- (iii) a copy (free of charge) of each of the plans, drawings, specifications or other documents itemised above is being sent immediately in accordance with rule 7(4) to the bodies indicated below.

Indicate in boxes

☒

Fabric Advisory Committee of the Cathedral

☒

Historic England (formerly English Heritage)

[as applicable]

☒

The following national amenity societies:

- Ancient Monuments Society
- The Council for British Archaeology
- The Georgian Group
- The Society for the Protection of Ancient Buildings
- The Victorian Society
- The Twentieth Century Society

☐

Local Planning Authority *only if the proposal is for works as described in section 2(1)(a) of the Measure*

Signed: 

Administrator on behalf of the Chapter

Dated: Monday 19th July 2021

FORM 8 (Rule 7)

Section 8 of Care of Cathedrals Measure 1990 (as amended)

Application to the Cathedrals Fabric Commission for approval of a proposal

To the Cathedrals Fabric Commission (“the Commission”)

The Chapter of the Cathedral Church of:

Christ in Liverpool

Postal address, including postcode of the administrator or any other person dealing with the application:

The Clerk to the Cathedral Committees,

Liverpool Cathedral,

St James’ Mount,

Liverpool L1 7AZ

E-mail address: philip.daniel@liverpoolcathedral.org.uk

applies to the Commission for approval of the following proposal:

The Proposal

Remove two existing pendant type lights from the Lady Chapel antechapel and install four soffit mounted LED fittings and four wall up lights.

Summary of the nature of the work and its extent (and materials) [or in the case of an object, a short description of it and details of the proposal]

The new lighting in the Josephine Butler Memorial Space is intended to be simple and non-intrusive whilst providing sufficient light for visitors to enjoy and interpret the space as well as experience its envisaged ambience of peace and contemplation.

Approaching the space from the Lady Chapel the visitor will be aware of a soft downlight to the area before the central column. They will then be aware of a gentle uplight from the inner faces of the central column between the two arches, highlighting the ribbed vaulting that springs to the north and south. The JCA Project Paper refers to the effect of angel’s wings spreading across the space and this was successfully demonstrated at the January lighting trials. Beyond the central column two more downlights, fitted to the timber panelled ceiling, will illuminate space in the west bay. All of the lighting will be softly focused and use warm white light sources (2700K). All of the lighting will be dimmable so that the correct level of light can be set for each element. The downlights before and after the central column will be independently controllable, the uplights will be on a third circuit.

The light fittings have been chosen to be as simple in design as possible and non-intrusive in respect of the architecture and fabric. They are to be finished in RAL 8025 [pale brown], a colour already used for loudspeakers in the Lady Chapel. Thus, they will be as unobtrusive when they are turned off as when they are on. The light fittings utilise remote LED drivers meaning that the massing of the fittings is reduced and that only light weight, low-voltage cables are required to the fittings themselves. The remote drivers can be located in the timber cupboards to the north side of the space and cables be run in raked out mortar joints from the fitting locations back to the cabinets. With the controllers positioned in the cupboards, pre-set dimmed levels can be set that will then be switched on and off on a daily basis. The levels will be able to be changed by authorised staff only.

Plans, drawings, specifications or other documents

The proposal is described by the following items which accompany this form:

Josephine Butler Memorial Space Lighting Statements
Josephine Butler Memorial Space Lighting 4031DSv3

DISPLAY OF PUBLIC NOTICE

I confirm that

- (i) a Public Notice in Form 9 is being displayed from the date of this application;
- (ii) a copy of the Public Notice in Form 9 is being sent immediately to the following bodies specified in rule 7(3) and (4) and as indicated below;
- (iii) a copy (free of charge) of each of the plans, drawings, specifications or other documents itemised above is being sent immediately in accordance with rule 7(4) to the bodies indicated below.

Public Notice

☒

Fabric Advisory Committee of the Cathedral

Copy plans etc.

☒

English Heritage

☒☒

The national amenity societies (or such person* as those societies have jointly appointed for the purposes of the Measure)

☒

If the proposal is for works described in section 2(1)(a) of the Measure—

☒

Local Planning Authority

☒

Signed: Philip Daniel

On behalf of the Chapter

Dated: 23 July 2021

Notes

1. The national amenity societies are the Ancient Monuments Society, the Council for British Archaeology, the Georgian Group, the Society for the Protection of Ancient Buildings, the Victorian Society and the Twentieth Century Society.

2. This form and all the accompanying items in it should be sent to the secretary of the Cathedrals Fabric Commission at the Commission's published address.

FORM 8 (Rule 7)

Section 8 of Care of Cathedrals Measure 1990 (as amended)

Application to the Cathedrals Fabric Commission for approval of a proposal

To the Cathedrals Fabric Commission ("the Commission")

The Chapter of the Cathedral Church of:

*Insert name of
cathedral.*

NORWICH

*Insert full postal
address and contact
telephone and fax
numbers and e-mail
address.*

Postal address, including postcode of the administrator or any other person dealing with the application:

THE CHAPTER OFFICE
65 THE CLOSE
NORWICH
NR1 4DH

Telephone number: 01603 218300

E-mail address: chaptersteward@cathedral.org.uk

applies to the Commission for approval of the following proposal:

*Short description e.g.
repair of stonework,
sale of silver.*

The Proposal

To install a wooden crucifix in the south east corner of the east Cloister Walk.

Summary of the nature of the work and its extent (and materials) [or in the case of an object, a short description of it and details of the proposal]

To install a wooden crucifix in the first bay of the south east corner of the east Cloister Walk. The crucifix would be hung utilising fixings drilled into mortar joints.

Plans, drawings, specifications or other documents

The proposal is described by the following items which accompany this form:

*List and number the
items and give
reference numbers, if
applicable.*

1. Details of crucifix
2. Plan of Cloister detailing proposed location of crucifix
3. Super imposed image of crucifix in the Cloister



DISPLAY OF PUBLIC NOTICE

I confirm that

- (i) a Public Notice in Form 9 is being displayed from the date of this application;
- (ii) a copy of the Public Notice in Form 9 is being sent immediately to the following bodies specified in rule 7(3) and (4) and as indicated below;
- (iii) a copy (free of charge) of each of the plans, drawings, specifications or other documents itemised above is being sent immediately in accordance with rule 7(4) to the bodies indicated below.

Public Notice

Tick boxes to indicate.

☒

Fabric Advisory Committee of the Cathedral

Copy plans etc.

☒

English Heritage

☒

** If none, then notice is to be given to each amenity society listed below.*

☒

The national amenity societies (or such person* as those societies have jointly appointed for the purposes of the Measure)

☒

If the proposal is for works described in section 2(1)(a) of the Measure—

☒

Local Planning Authority

☒

Neil Parsons
Signed: NEIL PARSONS – CHAPTER STEWARD

Administrator on behalf of the Chapter

Dated: 28 August 2020

Notes

1. The national amenity societies are the Ancient Monuments Society, the Council for British Archaeology, the Georgian Group, the Society for the Protection of Ancient Buildings, the Victorian Society and the Twentieth Century Society.
2. This form and all the accompanying items in it should be sent to the secretary of the Cathedrals Fabric Commission at the Commission's published address.

Cloister Crucifix Proposal



The image is the work of the French religious community known as *The Monastic Family of Bethlehem of the Assumption of the Virgin and of St Bruno*. Much of their work is done in this characteristically Romanesque style. The website states:

(<https://translate.google.co.uk/translate?hl=en&sl=fr&u=https://www.bethleem.org/&prev=search>)

The craft of the monks and nuns is not only the means of earning the daily bread of each monastery but also a service of Church. This Christian art wants to be an expression of faith, an unveiling of the Mystery of God which is Beauty and Goodness, and into which man is called to enter. Religious crafts such as icons, statues, medals, chalices, incense, etc. and crafts of profane objects such as hand-painted stoneware or earthenware, candles, sandals, cookies, etc... are carried out in the workshops of the monasteries according to the skills of each. Far from breaking the momentum of prayer, this work accomplished in toil and fatigue, purifies the heart and intensifies union with God as well as communion with the men and women of the whole world who toil to feed their families. These works of art are content to sing the Invisible. Their goal is achieved if those who contemplate them are carried beyond themselves in a certain silence of worship.

The community makes crucifixes in many sizes, some with crosses and some without, but this is the only one they make that would be large enough (1.85m. 6 ft) for its setting in the Cloisters.

Based on HBRU survey drawing 1998_Level01.dwg.

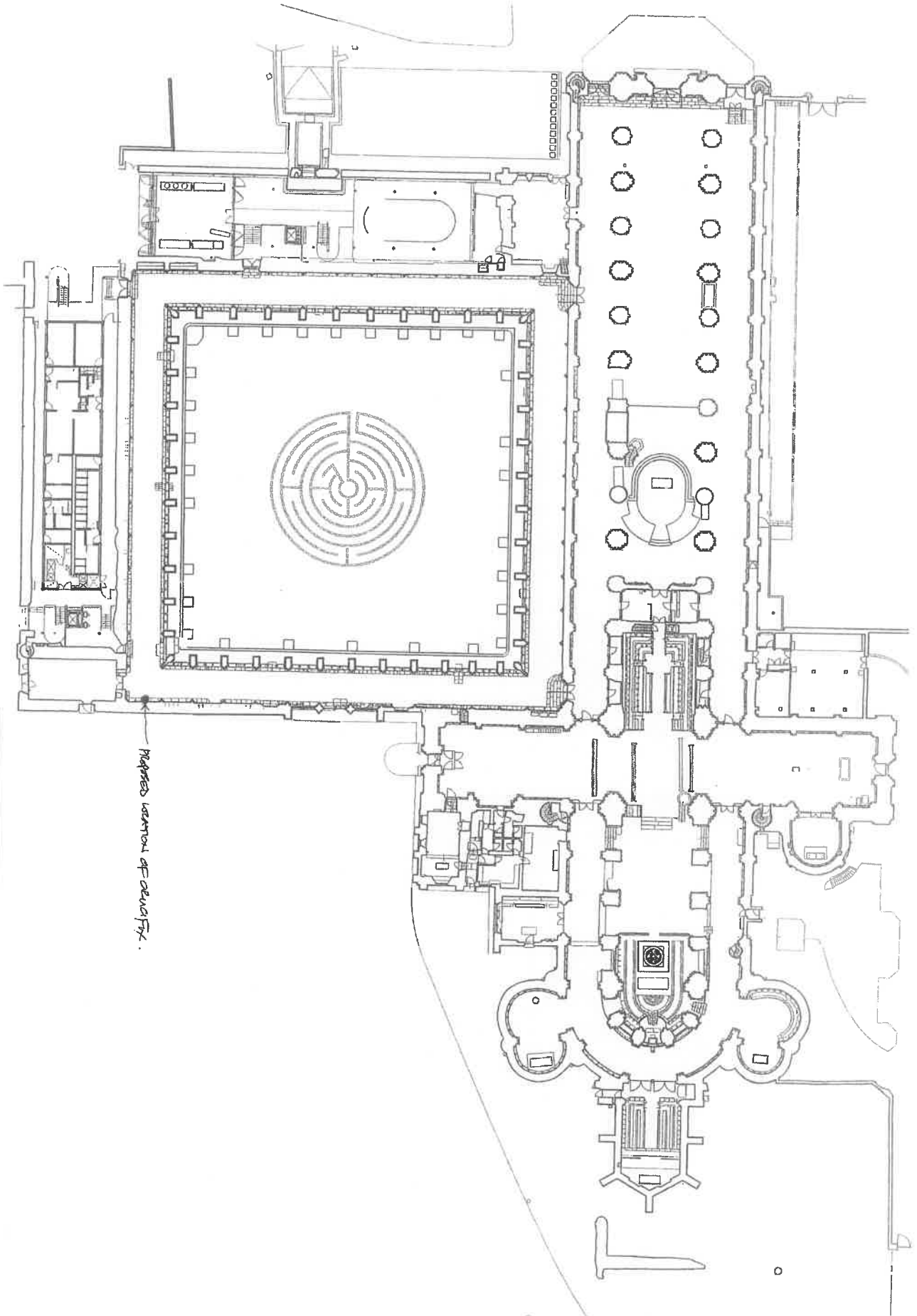

Proposed location of display case.

NORWICH CATHEDRAL

CONSERVATION MANAGEMENT PLAN FOR NORWICH CATHEDRAL

GROUND (LEVEL 1)

8.2 | 1

| | | | |
|----------------|------------------------------------|-----------------|--|
| drawing title | | drawing number | |
| Plan: Location | | 1 | |
| client | THE CATHEDRAL OF NORWICH CATHEDRAL | job title | CONSERVATION MANAGEMENT PLAN FOR NORWICH CATHEDRAL |
| author | THE CATHEDRAL OF NORWICH CATHEDRAL | date | 20.07.11 |
| editor | THE CATHEDRAL OF NORWICH CATHEDRAL | revision number | 1 |
| date | 20.07.11 | revision number | 1 |

FREELAND REES ROBERTS ARCHITECTS

21-23 The Quadrant, Cambridge, CB1 1UP
tel 01223 366555 fax 01223 313886 info@freelandrees.co.uk



FORM 9 (Rule 7)

Section 9 of Care of Cathedrals Measure 2011 Public Notice on application to the Cathedrals Fabric Commission

PUBLIC NOTICE

TAKE NOTICE that the Chapter of the Cathedral Church of:

The Cathedral and Metropolitan Church of St Peter in York

has on this date:

16th August 2021

applied to the Cathedrals Fabric Commission for approval of the following proposal:

To place a statue of Her Majesty Queen Elizabeth II on the West Front of York Minster

Summary of the nature of work and its extent (and materials) [or in the case of an object, a short description of it and details of the proposal]

A statue of Her Majesty The Queen is to be placed on an empty niche at the West Front of York Minster to mark the platinum jubilee as part of the early implementation of Policy PA2 of the emerging York Minster Neighbourhood Plan.

Plans, drawings, specifications or other documents

Copies of the plans, drawings, specification and other documents accompanying this application may be examined online at statutoryapplications.yorkminster.org

REPRESENTATIONS

If you wish to make representations about the whole or any part of the proposal described in this Notice you should write to

The Secretary of the Cathedrals Fabric Commission:

c/o Rosie Smith
Cathedrals Officer
Cathedrals and Church Buildings Division
Church House
Great Smith St
London
SW1P 3AZ
rosanna.smith@churchofengland.org
020 7898 1862

So that it reaches the Secretary not later than:

13th September 2021

DIRECTIONS TO CHAPTER

1. This public notice (or a copy of it) must be displayed for a continuous period of 28 days in a prominent position inside and outside your cathedral where it is readily visible to the public.

2. A copy of this notice must be sent as follows:

- (a) to the Fabric Advisory Committee of your Cathedral Church
- (b) to Historic England (formerly English Heritage)
- (c) if the proposal is of a kind described in section 2(1)(a) of the Measure—
 - (i) to the national amenity societies as applicable (see list on Form 8)
 - (ii) to the local planning authority.

| | |
|---|---------------------------------|
| <div><div>Statutory Notice</div><div>This notice must remain on public display at all times. Do not remove or obscure this notice in any way.</div></div> | |
| Date notice displayed | 16 th August 2021 |
| Not to be removed before | 14 th September 2021 |

